

A

B

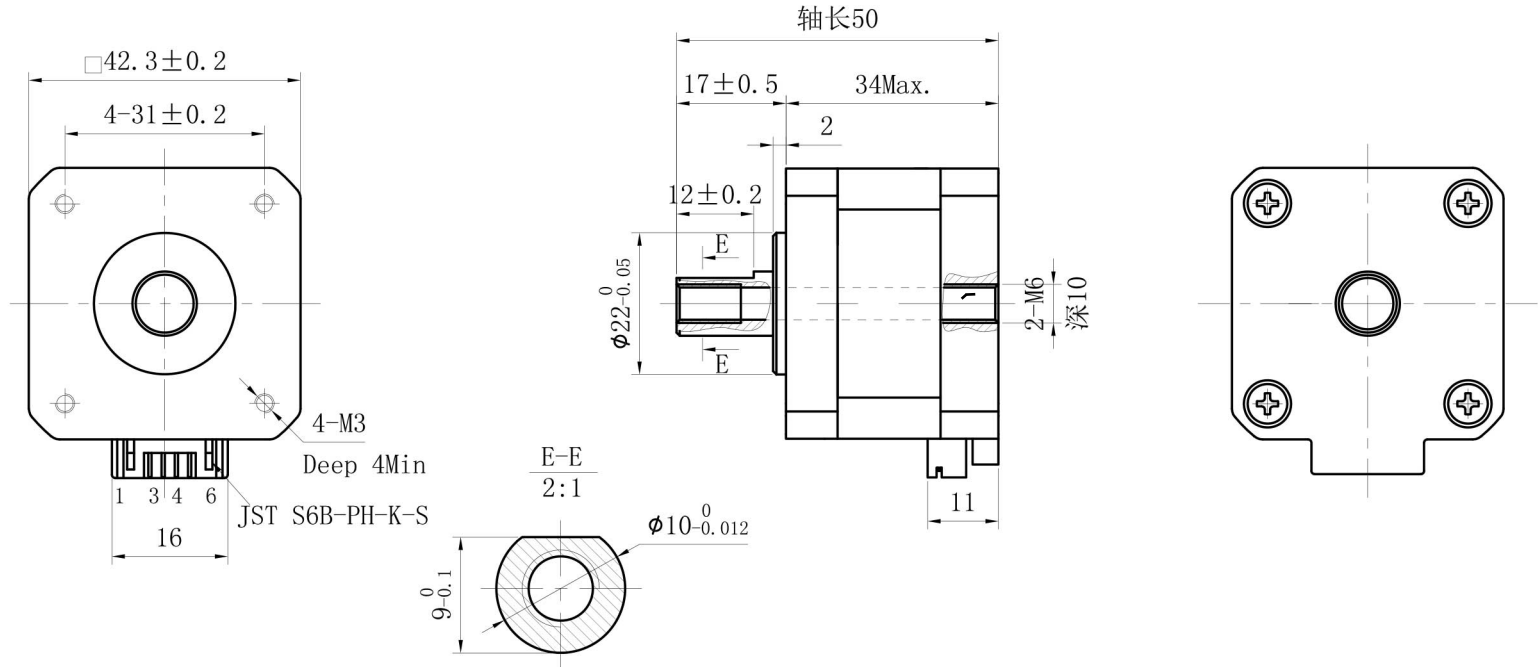

Phase	2	Rated Operating Status	Continuous
Step Angle	1.8°	Lifetime (Hours)	Above 5000H
Step Angle Error (No Load)	±0.09° or below	Temperature Rise	Below 80K
Current	1.5 A	Insulation Withstand Voltage	500V A.C
Resistance (Phase)	1.56 Ω±10%	Insulation Resistance	Above 100 MΩ
Inductance (Phase)	2.4 mH±20%	Insulation Class	B
Holding Torque	0.26 N.m	Operating Temperature Range	0° C~+50° C
Rotor Inertia	≈38 g.cm <sup>2</sup>	Operating Humidity Range	20%RH~90%RH
Weight	≈0.2 KG	Storage Temperature Range	-20° C~+70° C
Radial Runout	0.025 MM(Load 450g)	Storage Humidity Range	15%RH~95%RH
Axial Runout	0.005 MM(Load 920g)		

图纸编码

MZ17-0002

物料代码

MS.07-17AB4-034A-01

版本 Rev

A1.0

变更内容  
Revision Record

初次发放

签字 The signature

日期 Date

Wire Color and Connection Diagram of the Motor

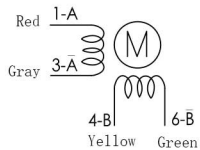

Note: The color and order of the motor leads are subject to the actual object.

Excitation Sequence (2-Phase Excitation)

Step	A	B	A-	B-
1	+	+	-	-
2	-	+	+	-
3	-	-	+	+
4	+	-	-	+

Initial Direction: Follow the excitation sequence in the table, observing the clockwise direction from the mounting surface.

Label Content

Motor Model

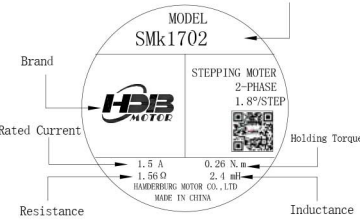

客户签字确认

标记	处数	更改文件号	签名	年月日
设计		标准化		
校核		工艺		
审核		批准		
图样标记	H			

视图方式:



比例 1:1

SMK1702

TWO-PHASE HOLLOW SHAFT STEPPER MOTOR



WWW.HDBMOTORS.COM

共 1 张 第 1 张